

Location

Location Map

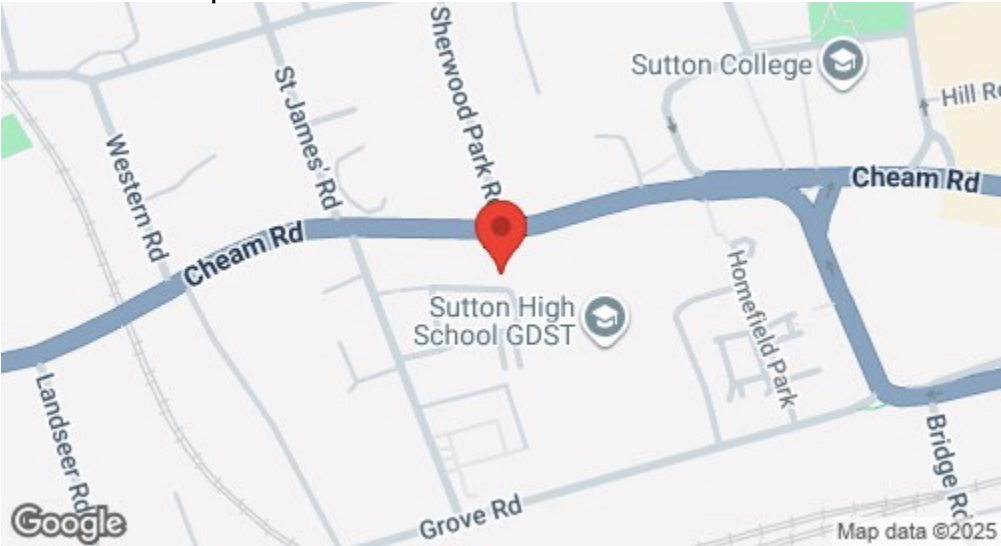

EPC Graph

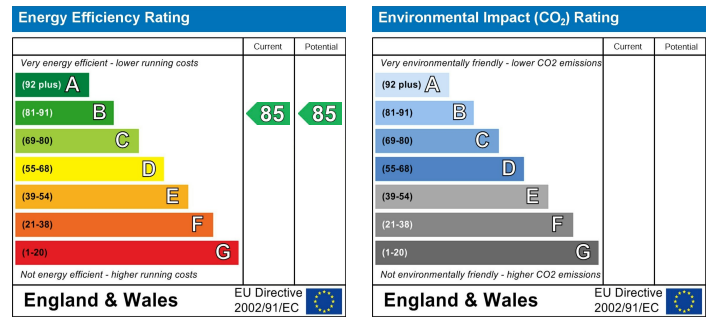

Important Note

Centro Residential Sales and Lettings limited have not tested any services, heating system, electrical system, appliances, fixtures and fittings, that may be included in this property and would advise interested parties to satisfy themselves as to their condition or investigating the presence of any deleterious materials.

Viewing: Strictly by appointment through:

CENTRO RESIDENTIAL SALES AND LETTINGS LIMITED

Tel: 020 8401 5000

E-mail: residential@centro.plc.uk

See a selection of our properties at www.centro.plc.uk

£2,400 Per Month - 11th February 2026

Cheam Road, Sutton, SM2 7LQ



Description

- New Development
- Two Bedrooms
- Two Bathrooms
- Impeccable Finish
- Fitted Kitchen
- Built In Wardrobes
- Gated Parking
- Private Garden
- Council Tax Band : D
- EPC Rating : B

Features

- New Build
- Double Glazing
- Neutral Décor

What you need to know

- Term: 12 months
- Rent: £2500pcm exclusive of bills
- Security deposit: £2884
- Council Tax Band D
- Energy Rating: B



Floor Plan

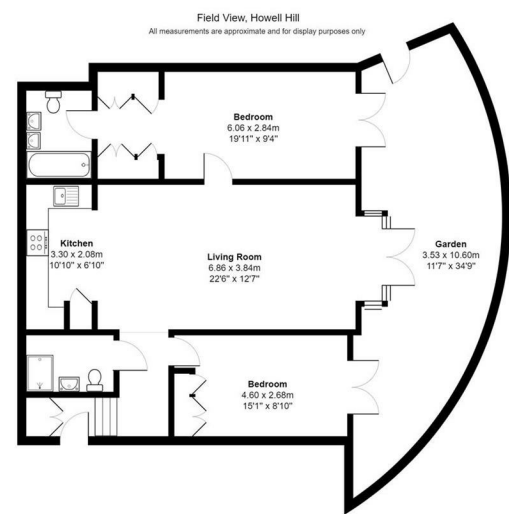

For illustration purposes only



All dimensions and measurements are approximate and for guidance only.

Just Centro's Opinion...

A stunning luxury two-bedroom, two-bathroom apartment finished to an impeccable standard throughout, located on Cheam Road, ideally positioned between Cheam Village, Ewell, and Banstead.

This impressive ground-floor apartment features a spacious living area, a fitted kitchen with Neff appliances, a large principal bedroom with built-in wardrobes and an en-suite shower room, a second double bedroom, and a modern family bathroom. The property also benefits from direct access to a private patio garden from both bedrooms and the living area.

Further benefits include gated parking, a video entry system, bike storage, additional communal grounds, and a high-end finish throughout.

Offered unfurnished and available in February. Viewings are available now.

Additional Photos

